

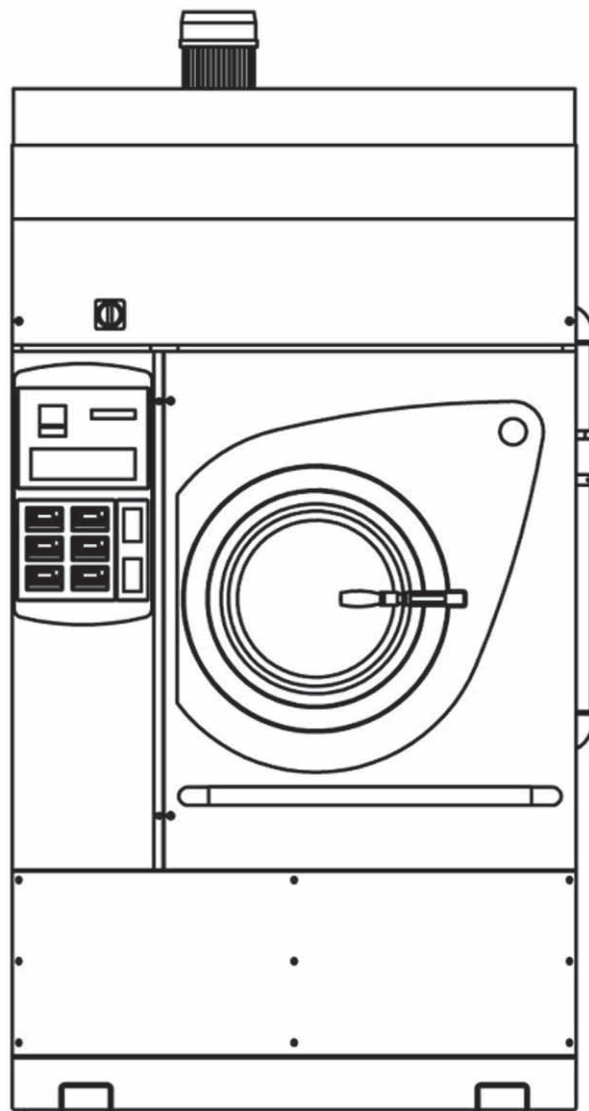

FIRBIMATIC

DRY CLEANING DIVISION

TECHNICAL INFORMATION



Essic. 20kg

TECHNICAL INFORMATION

WORKING MACHINE WITH SOLVENT	HYDROCARBON / WATER	
MACHINE CAPACITY	20 Kg	50 Lbs

BASKET		
Diameter	1000 mm	39.4 inches
Depth	510 mm	20.1 inches
Volume	400 Lt	14.1 cu.ft
Basket speed	40 rpm	
Door opening	500 mm	20 inches

SOLVENT TANKS		
Useful volume tank 1	75 Lt	19.8 gal
Useful volume tank 2 (Optional)	- Lt	- gal
FLOOR SAFETY TANK CAPACITY	204 Lt	54 gal

ELECTRIC POWER	400 V - 50HZ		220 V - 60HZ	
	Basket motor-reducer (With Inverter)	*2.7 Hp	*2 Kw	*2.7 Hp
Fan motor	3 Hp	2.25 Kw	5.5 Hp	4.13 Kw
Refrigerator compressor	6.5 Hp	4.85 Kw	6.5 Hp	4.85 Kw
Air motor compressor (optional)	0.5 Hp	0.37 Kw	-	-

* POWER CHANGES ACCORDINGLY TO THE USE OF THE MACHINE

NOTE: Acoustic emission level of the machine is lower than 70 dB (A)

DIMENSIONS AND WEIGHTS

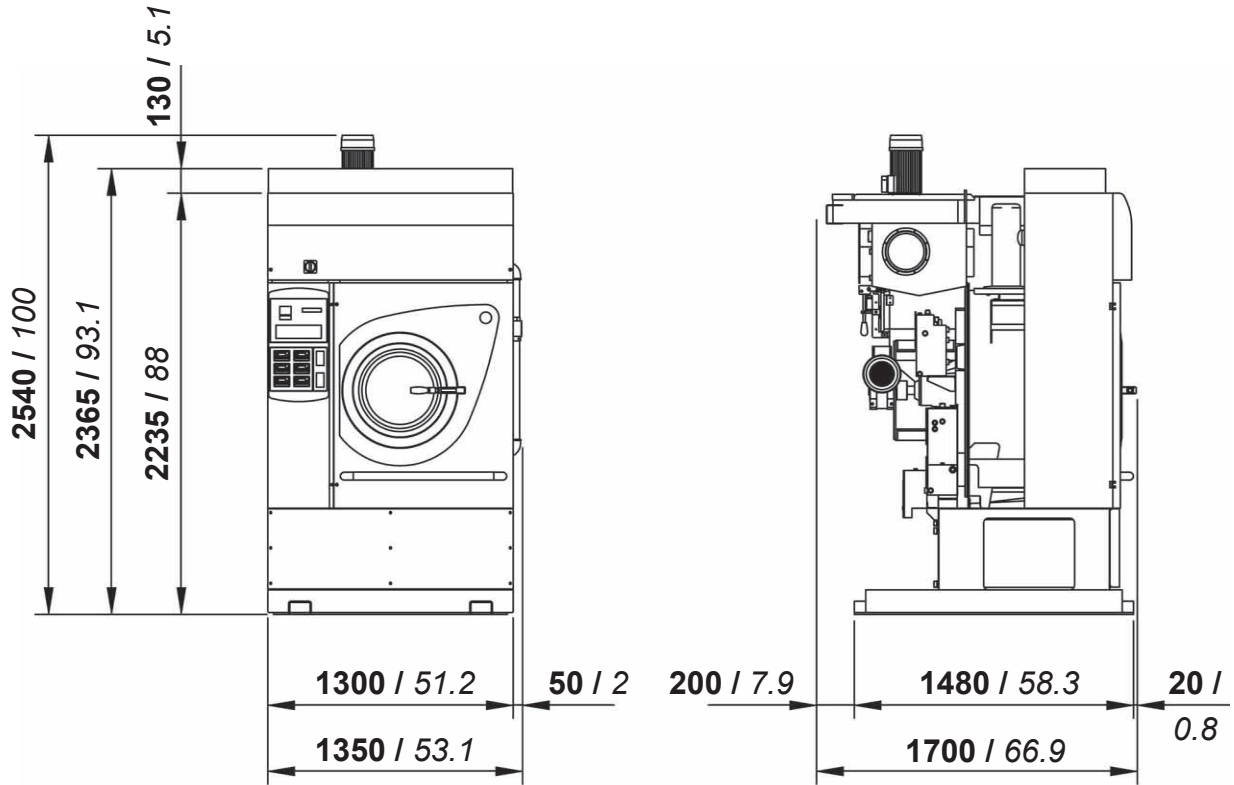

mm / inches

CHARGES - STANDARD VERSION		
Empty machine weight	1290 Kg	2844 Lbs
Machine weight with solvent	1365 Kg	3009 Lbs
Static charge on the floor with solvent	775 Kg/m²	159 Lbs/ft²
Dynamic charge on the floor (+10%)	855 Kg/m²	175 Lbs/ft²

TECHNICAL INFORMATION

PACKAGED MACHINE DIMENSIONS AND WEIGHTS

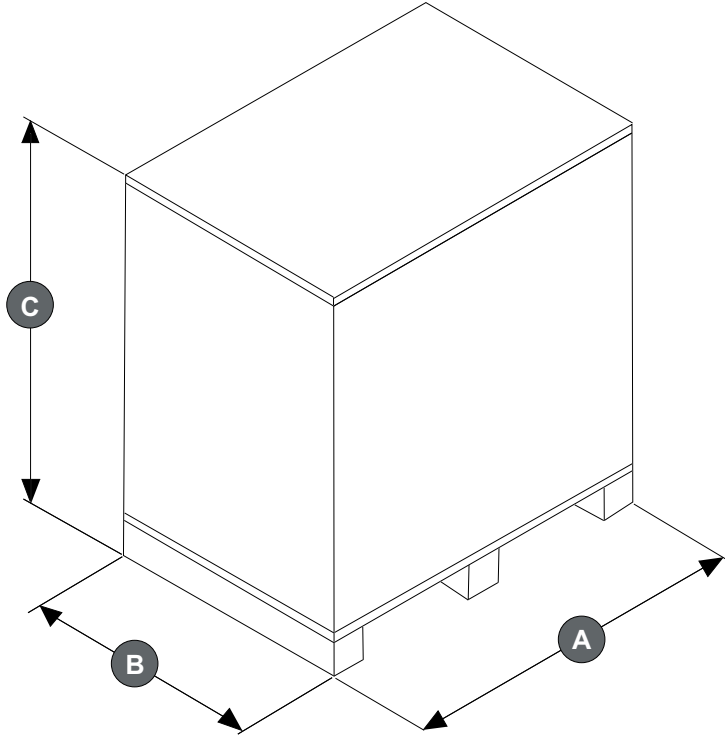

PACKAGED MACHINE DIMENSIONS							
Machine type		Carton		Wooden cage		Wooden case	
Standard	A	- mm	- inches	- mm	- inches	- mm	- inches
	B	- mm	- inches	- mm	- inches	- mm	- inches
	C	- mm	- inches	- mm	- inches	- mm	- inches

PACKAGED MACHINE WEIGHTS						
Machine type	Carton		Wooden cage		Wooden case	
Standard	- Kg	- Lbs	- Kg	- Lbs	- Kg	- Lbs

Essic. 20kg

USEFUL INSTALLATION INFORMATION

FIXING POINTS WITH FLOOR TANK

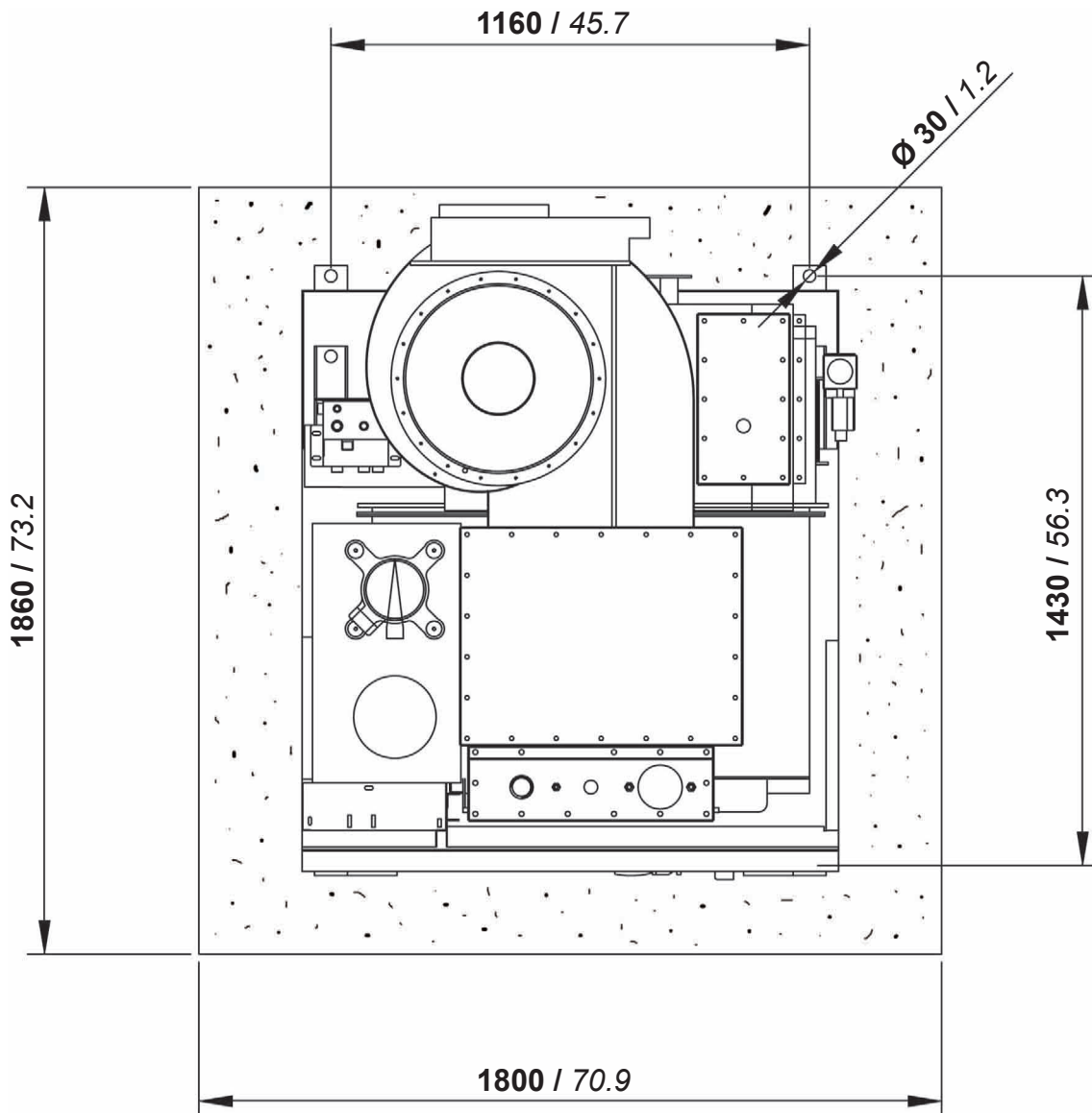
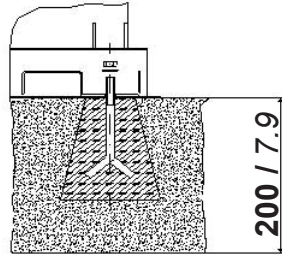

mm / inches



USEFUL INSTALLATION INFORMATION

CONNECTIONS

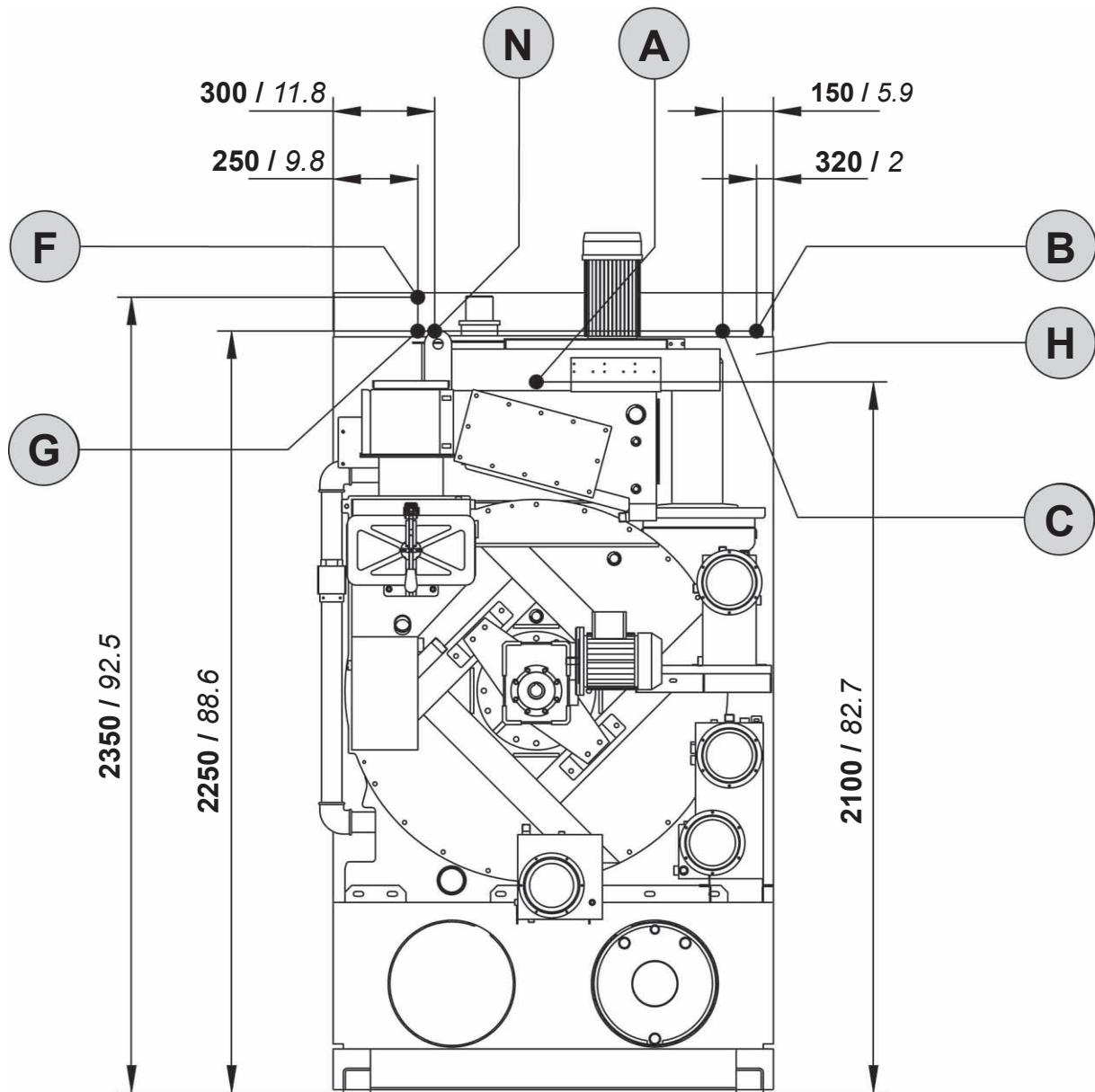

mm / inches

A	Compressed air inlet	mm 6	Ø 1/4"
B	Water inlet	Ø 1"	
C	Water outlet	Ø 1"	
D	-	-	
E	-	-	
F	Steam heater inlet	Ø 1/2"	
G	Condensate heater outlet	Ø 1/2"	
H	Electric connection		
N	Nitrogen feeding connection (N ₂)		

INFORMATION FOR THE ELECTRICAL CONNECTIONS		(400 V - 50 Hz)	
Standard Version		10.5 Kw	35 Amp
Dissipated heat		- Kcal	

INFORMATION FOR THE ELECTRICAL CONNECTIONS		(220 V - 60 Hz)	
Standard Version		12.5 Kw	45 Amp
Dissipated heat		- Kcal	

GENERAL INFORMATION		
Required water capacity for Refrigerator	Lt/min 10	<i>gal/min 2.6</i>
Required water pressure for Refrigerator	bar 2 ÷ 3	<i>psi 29 ÷ 44</i>
Required water temperature for Refrigerator	°C 18 ÷ 23	<i>°F 65 ÷ 73</i>
Required air pressure	bar 7 ÷ 8	<i>psi 100 ÷ 115</i>
Required steam pressure (Steam Version)	bar 4 ÷ 5	<i>psi 55 ÷ 70</i>
Required steam availability	Kg/h 15 ÷ 20	<i>Lbs/h 33 ÷ 44</i>

All technical data are subject to change without notice.

